

XAJE P



Self-priming Jet centrifugal pump with electronic system



Technopolymer check valve with flow control disc and spring in AISI 316 (standard equipment in automatic version)

Description

Up/Down technology for submersed, surface or underground installation
Automatic system of water supply;
dry-running protection
Antiblocking system every 72 hours of pump inactivity
Protection rating IP 68

Applications

- Domestic boosting
- Medium sprinkling and surface irrigations
- Tank drainage and transfers

Pumped liquid:

Clean water with no abrasive or suspended solids

Liquid temperature +2°C ÷ +40°C

Air temperature max +45°C

Depth max 5 m

Calibrating pressure rate switch 1,5 bar

Materials

- Motor body: Stainless steel AISI 304
- Technopolymer flange and pump body
- Shaft: Stainless steel AISI 420
- Diffuser, impeller and venturi Jet: Noryl
- Rear cap: Polypropilene
- Basis: Stainless steel AISI 304
- Dumping feet: rubber
- Mechanical seal: Graphite ceramics
- Oil chamber on the mechanical seal
- A2 Stainless steel bolts
- NBR70 O-ring
- H07RN8-F Electric cable 10m length with Schuko plug
- Tropicalized circuit board in compliance with the RoHS directive
- Class F insulated motors

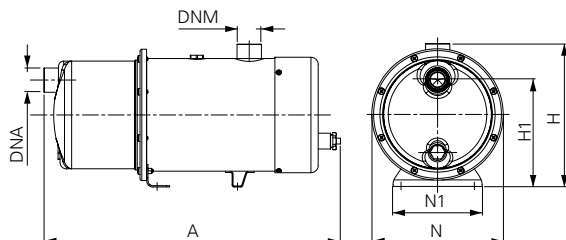

Code	P ₂ Nom.		3 ~ 50Hz Amp.		1 ~ 50Hz Amp.	Cap µF	Q (lt/m) Flow							Dimensions mm						Wgt. kg		
	kW	Hp	230 V	400 V	230 V		0	10	20	30	40	50	60	A	N	H	H1	N1	DNM		DNA	
	Total Hm in CA																					
AUTO 1-PH	XAJE80P	0,60	0,8	-	-	4,5	16	40	33	30	24	20	15	-	447	200	226	163	136	1 1/4	1"	11,5
	XAJE100P	0,75	1	-	-	5,3	16	47	40	35	30	25	20	5	477	200	226	163	136	1 1/4	1"	12
	XAJE120P	0,90	1,2	-	-	5,9	18	51	45	40	34	30	24	8	477	200	226	163	136	1 1/4	1"	13
MAN 1-PH	XJE80P	0,60	0,8	-	-	4,5	16	40	33	30	24	20	15	-	447	200	226	163	136	1 1/4	1"	11,5
	XJE100P	0,75	1	-	-	5,3	16	47	40	35	30	25	20	5	477	200	226	163	136	1 1/4	1"	12
	XJE120P	0,90	1,2	-	-	5,9	18	51	45	40	34	30	24	8	477	200	226	163	136	1 1/4	1"	13
MAN 3-PH	XJE80PT	0,60	0,8	2,2	1,5	-	-	40	33	30	24	20	15	-	447	200	226	163	136	1 1/4	1"	11,5
	XJE100PT	0,75	1	3	1,9	-	-	47	40	35	30	25	20	5	477	200	226	163	136	1 1/4	1"	12
	XJE120PT	0,90	1,2	3,6	2,3	-	-	51	45	40	34	30	24	8	477	200	226	163	136	1 1/4	1"	13

Curves and performance $\eta = 2900$ 1/min

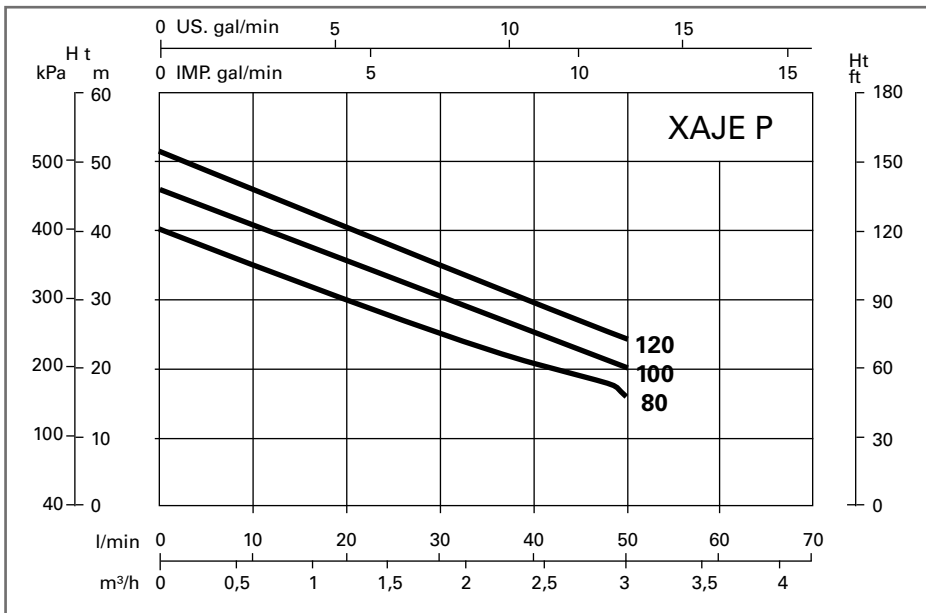

Technopolymer impeller



Cable fixing handle

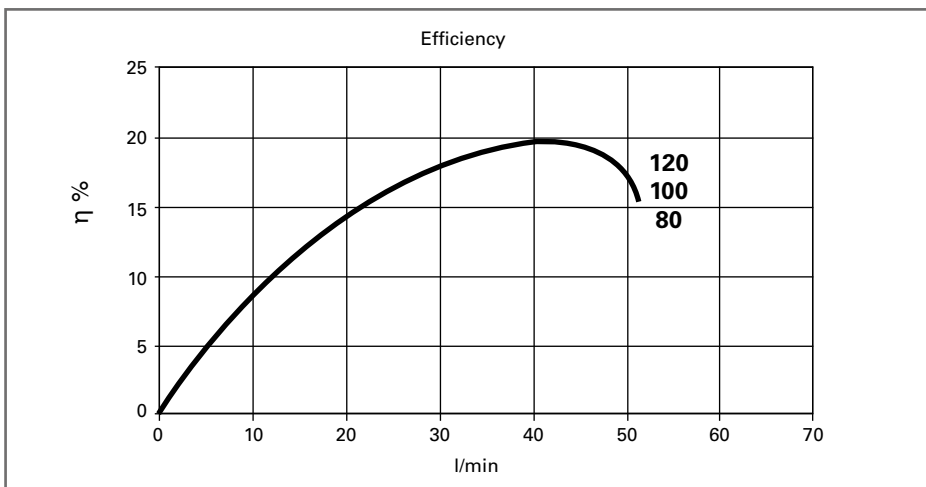

Motor body with delivery mouth

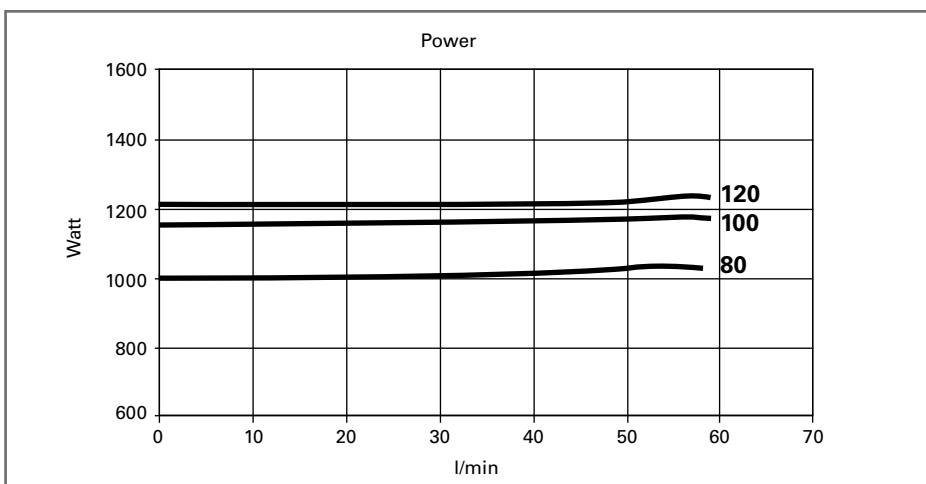

Technopolymer motor support