

XAMO B



Horizontal multistage pump with electronic system



Technopolymer check valve with flow control disc and spring in AISI 316 (standard equipment in automatic version)

Applications

- Domestic boosting
- Medium sprinkling and surface irrigations
- Tank drainage and transfers
- Industrial washing and cooling
- Systems for water treatment

Pumped liquid:

Clean water with no abrasive or suspended solids

Liquid temperature +2°C ÷ +40°C

Air temperature max +45°C

Depth max 5 m

Calibrating pressure rate switch 1,5 bar

Description

Up/Down technology for submersed, surface or underground installation

Automatic system of water supply; dry-running protection

Antiblocking system every 72 hours of pump inactivity

Protection rating IP 68

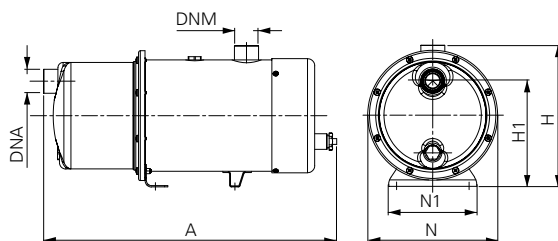

Materials

- Motor body, impellers and pump body: Stainless steel AISI 304
- Technopolymer flange
- Shaft: Stainless steel AISI 420
- Diffuser: Noryl
- Rear cap: Polypropylene
- Basis: Stainless steel AISI 304
- Dumping feet: rubber
- Mechanical seal: Graphite ceramics
- Oil chamber on the mechanical seal
- A2 Stainless steel bolts
- NBR70 O-ring
- H07RN8-F Electric cable 10m length with Schuko plug
- Tropicalized circuit board in compliance with the RoHS directive
- Class F insulated motors

	Code	P ₂ Nom.		3 ~ 50Hz Amp.		1 ~ 50Hz Amp.	Cap μF	Stages	Q (lt/m) Flow								Dimensions mm						Wgt.kg	
		kW	Hp	230 V	400 V	230 V			0	30	40	50	60	70	80	90	A	N	H	H1	N1	DNM		DNA
		Total Hm in CA																						
AUTO 1-PH	XAM080B	0,60	0,8	-	-	5,15	16	3	33	28	23	20	18	13	10	7	447	200	226	163	136	1"¼	1"	14,5
	XAM0100B	0,75	1	-	-	6,0	18	4	42	35	30	28	24	18	15	10	477	200	226	163	136	1"¼	1"	15
	XAM0120B	0,90	1,2	-	-	7,2	20	5	52	43	40	35	30	25	20	15	477	200	226	163	136	1"¼	1"	16
MAN 1-PH	XM080B	0,60	0,8	-	-	5,15	16	3	33	28	23	20	18	13	10	7	447	200	226	163	136	1"¼	1"	14,5
	XM0100B	0,75	1	-	-	6,0	18	4	42	35	30	28	24	18	15	10	477	200	226	163	136	1"¼	1"	15
	XM0120B	0,90	1,2	-	-	7,2	20	5	52	43	40	35	30	25	20	15	477	200	226	163	136	1"¼	1"	16
MAN 3-PH	XM080BT	0,60	0,8	2,4	1,6	-	-	3	33	28	23	20	18	13	10	7	447	200	226	163	136	1"¼	1"	14,5
	XM0100BT	0,75	1	3	2	-	-	4	42	35	30	28	24	18	15	10	477	200	226	163	136	1"¼	1"	15
	XM0120BT	0,90	1,2	3,3	2,5	-	-	5	52	43	40	35	30	25	20	15	477	200	226	163	136	1"¼	1"	16

Curves and performance $n = 2900$ 1/min

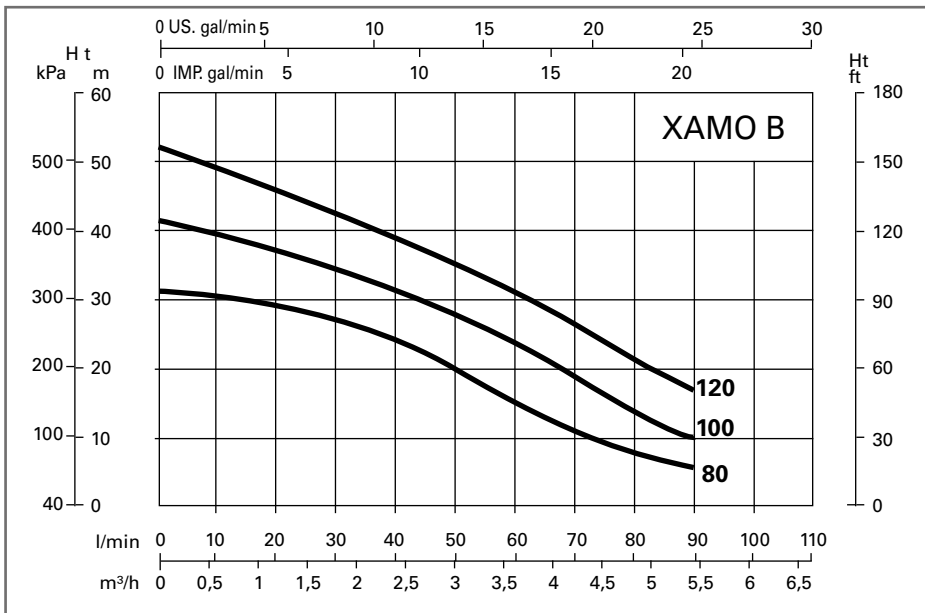

Impeller Stainless steel
AISI 304

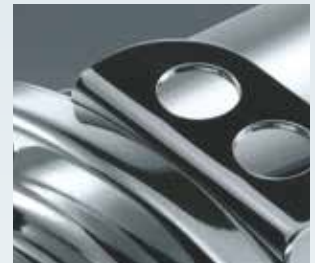

Cable fixing handle

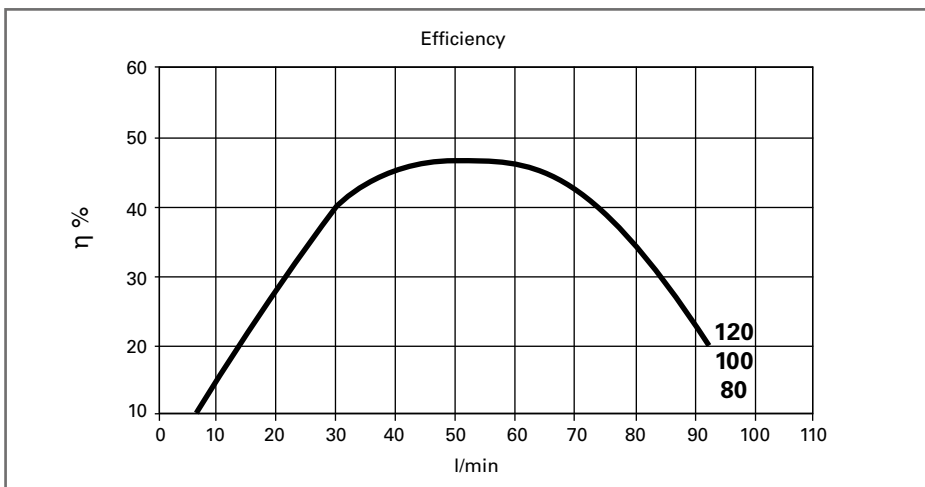

Motor body with delivery
mouth

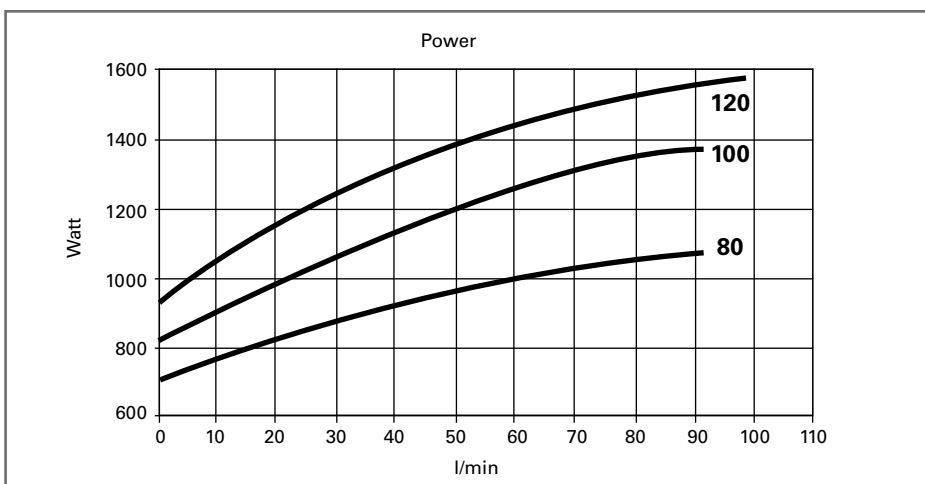

Technopolymer motor support